

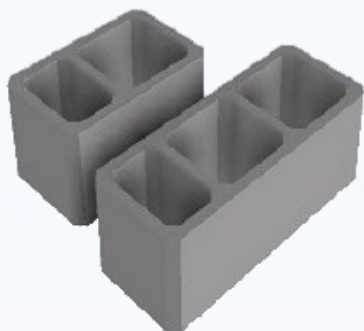

BCI ALGÉRIE
Certification ISO 9001



Chimney Shunts



**SAPCI est votre partenaire
sur chantier pour tous vos travaux
en Béton prêt à l'emploi**

**Unité de Production BPE
Ouled Heddadj 35052
W.Boumerdès
Mob.: 0560 02 57 85**



BÉTON PRÊT A L'EMPLOI

**Centre de production de BPE
Ouled Heddadj**



SAPCI votre partenaire depuis 1969
www.sapci-dz.com

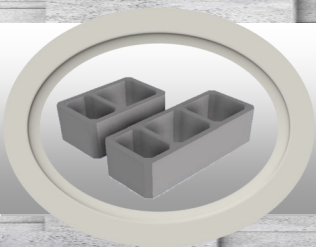

Chimney Shunts

Designation	Dimension [cm]			Unit weight [kg]	Number of pieces per pallet	Concrete grade [MPa]
	H	I	L			
SC 400	20	25	40	18	72	20



SC 400 Shunt

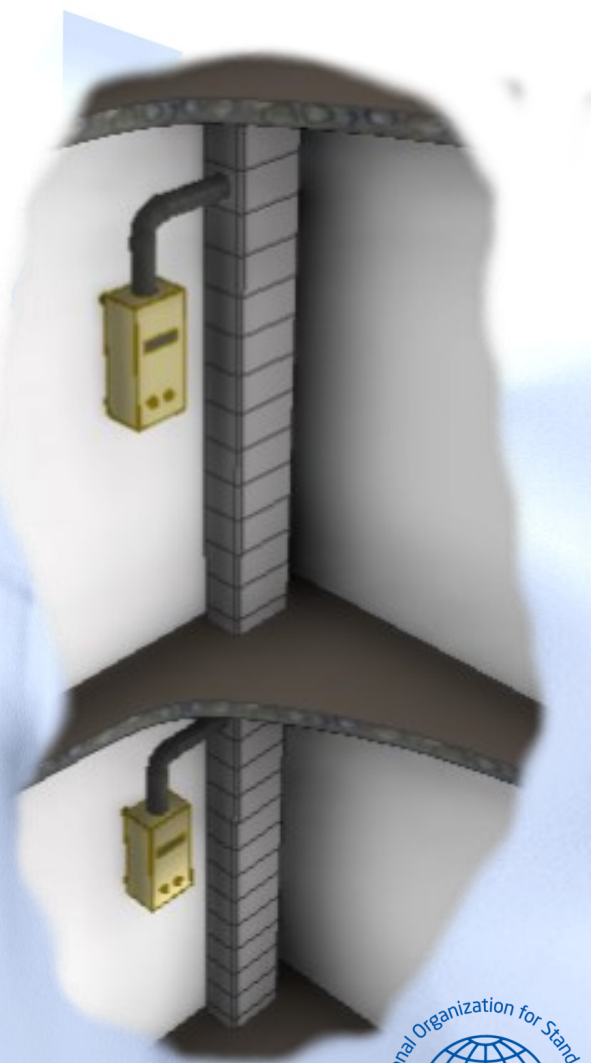
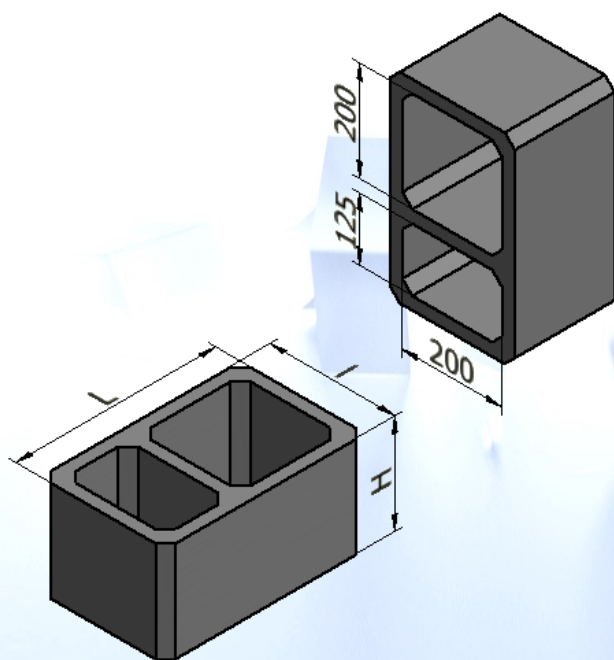

SC 400 shunts are used to conduct the combustion gases from each floor of a building in an individual channel of section ($S_i = 250\text{cm}^2$) towards a collective channel of suction ($S_c = 400\text{cm}^2$).

The **SC 400** shunt then allows to make up to five (05) connections (Floors).

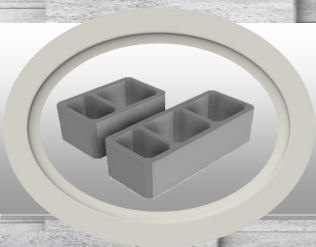

Chimney Shunts

Designation	Dimension [cm]			Unit weight [kg]	Number of pieces per pallet	Concrete grade [MPa]
	H	I	L			
SC 625	20	25	62.5	26	48	20



SC 625 Shunt

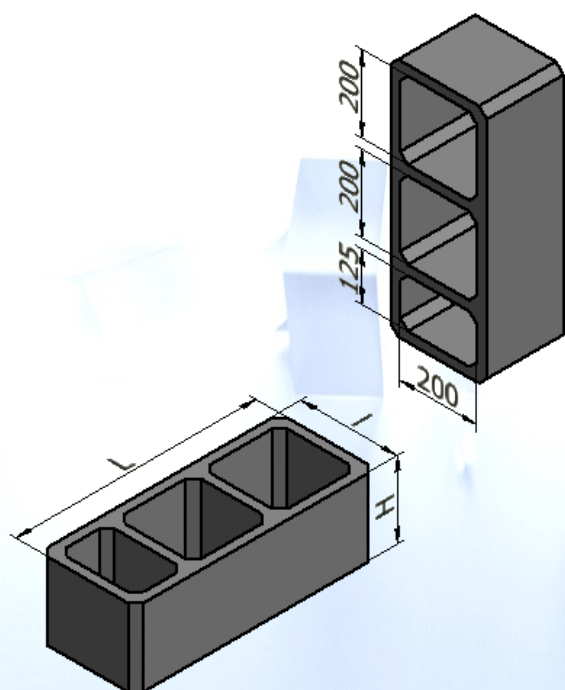

SC 625 shunts are used to conduct the combustion gases from each floor of a building in an individual channel of section ($S_i = 250\text{cm}^2$) towards a collective channel of suction ($S_c = 400\text{cm}^2$).

The **SC 625** shunt then allows to make up to **ten (10)** connections (Floors); **Five (05)** for each collective channel.

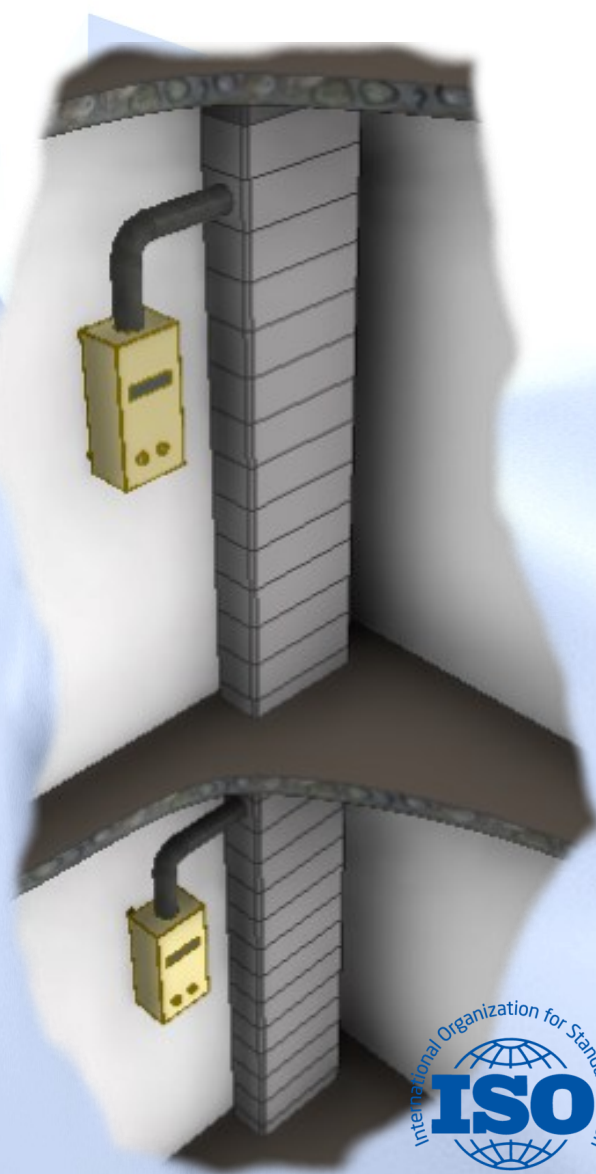

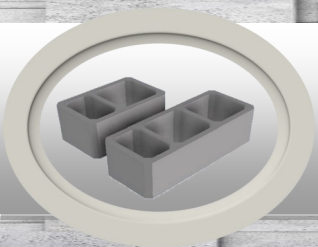

Chimney Shunts



Implementation

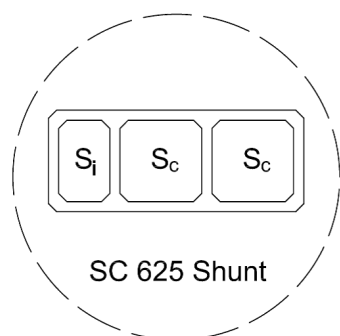

Section B-B

5th Floor

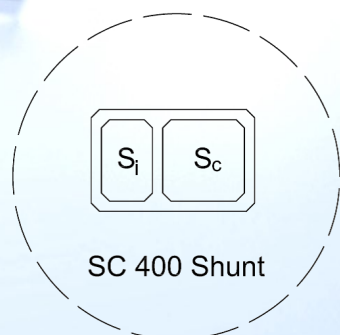

Section A-A

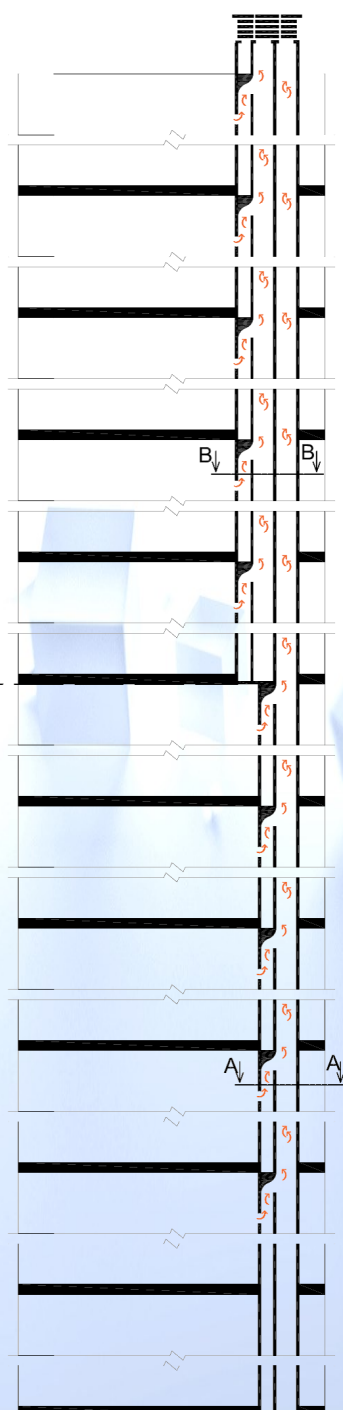

For economic reasons, when constructing a “shunt” chimney in buildings exceeding five (05) floors, it is recommended to use **SC 400** shunts up to the **5th floor** and then , continue with **SC 625** shunts.

